

INSTALLING AN M-COMPACT/R-BLACK ELECTRICAL SCREEN

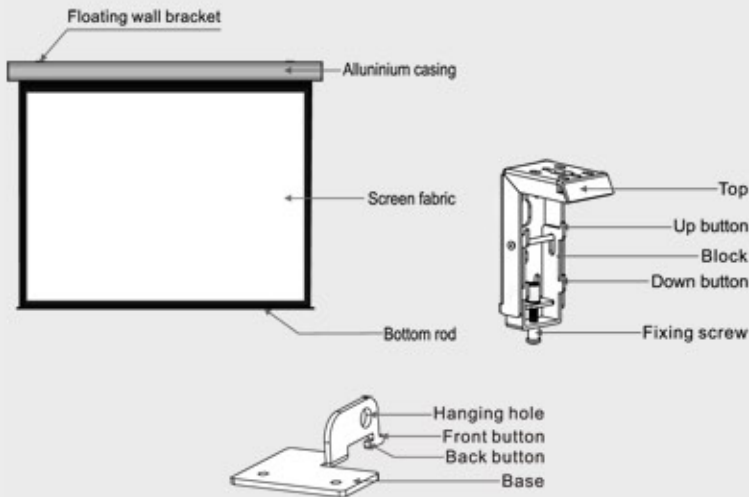

Description



Accessories

- Floating wall bracket (2pcs)
- $\varnothing 5 \times 40$ mm Tapping screw & cap (8sets)
- M5x10 Screw (4pcs)
- Ceiling hanger (2pcs)
- Allen key (1pc)
- Instruction manual (1pc)

SETTING UP THE SCREEN - general tips

- Check that the product is delivered complete and in undamaged condition before attempting to install the product.
- See whether it is physically possible to mount the screen in the intended place. Make allowance for the load-bearing capacity of the wall and the securing points.
- Make certain that the bottom of the screen hangs sufficiently high (between 100 cm and 125 cm clear of the floor for 4:3 and 70 cm and 90 cm for 16:9). This will provide optimum viewing comfort.
- Assembly is generally easier with 2 pair of hands.

INSTALLATION

There are three different ways to mount your screen.

- **Wall mounting** (requires use of the “floating wall bracket”)
- **Ceiling mounting** (requires use of the “floating wall bracket”)
- **Suspended ceiling mounting** (requires use of the “ceiling hanger” and additional hangers/hooks (not included))

Note: The ideal position for the mounting brackets is as close to the ends of the casing as possible.

A. WALL MOUNTING / CEILING MOUNTING

Use the supplied tapping screws with caps for concrete walls/ceilings, without caps for wooden walls/ceilings.

1. Position the brackets so that they are level

2. Drill the screws through the appropriate holes in the brackets

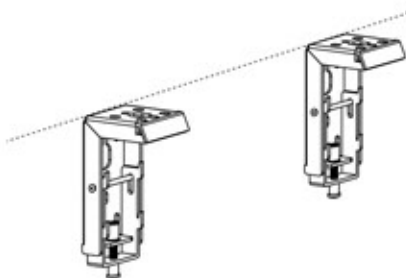

WOOD/WALL

WOOD/CEILING

CONCRETE/WALL

CONCRETE/CEILING

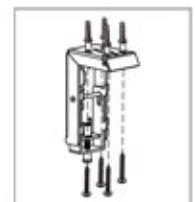

3. Loosen the fixing screw to lower down the block all the way

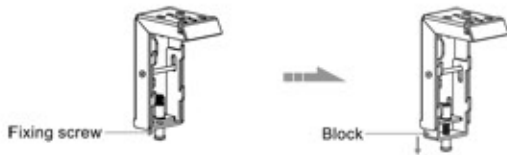

4. Slide the casing onto the ridges of the brackets



5. Fasten the fixing screws on the brackets so that the brackets fit tightly onto the casing of the screen



B. SUSPENDED CEILING MOUNTING

1. Mount your hangers/hooks (not included) to the ceiling

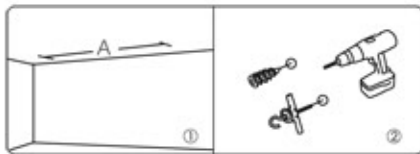

2. Put the ceiling hanger through the opening in the top part of the wall bracket and make sure it fits in correctly. Use the supplied M5x10 screws to keep the wall bracket and ceiling hanger together.

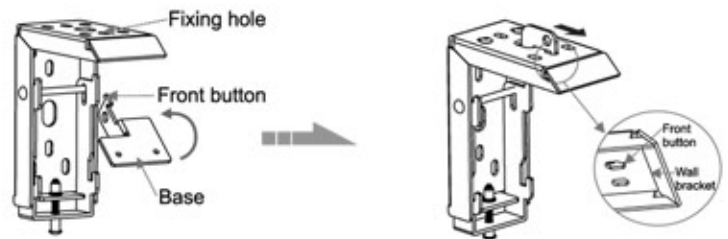

3. Slide the screen onto the brackets and fasten the fixing screw of the bracket to lock it.

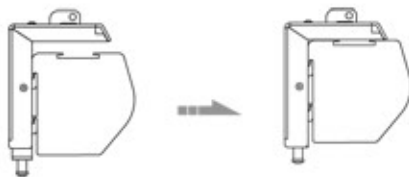

4. If everything is tightly fit together, you can hang the screen onto the hangers/hooks.

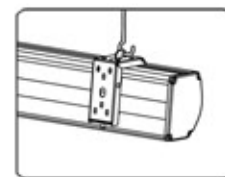

MAINTENANCE

A screen has a long service life provided it is used correctly. The following tips will help you to get the most out of your screen.

1. Protect the projection fabric from dust and smoke. Roll up when not in use.
2. Ensure when rolling up that the fabric is completely free of dust or other impurities.
3. Do not write on the fabric. It can be cleaned only to a limited extent, using a mild soap solution.
4. Do not leave the fabric exposed to direct sunlight for long periods. Direct sunlight may cause a yellow discoloration.

DISCLAIMER

The guarantee on the M-compact is 2 years. The guarantee ceases to apply if the screen is not installed correctly, opened or used for any other purpose other than for which it has been designed. Projection quality depends on many factors and will vary in different surroundings. Beamax can not offer any guarantee regarding perceived projection quality. Changes may be made without prior notice.

Tel: +32 11 40 30 90
UK free call: 0800 9175 943
E-mail: info@beamax.com

Visit www.beamax.com for the latest news on Beamax projection screens.