

INSTALLING AN R-SERIES/R-BLACK MANUAL SCREEN

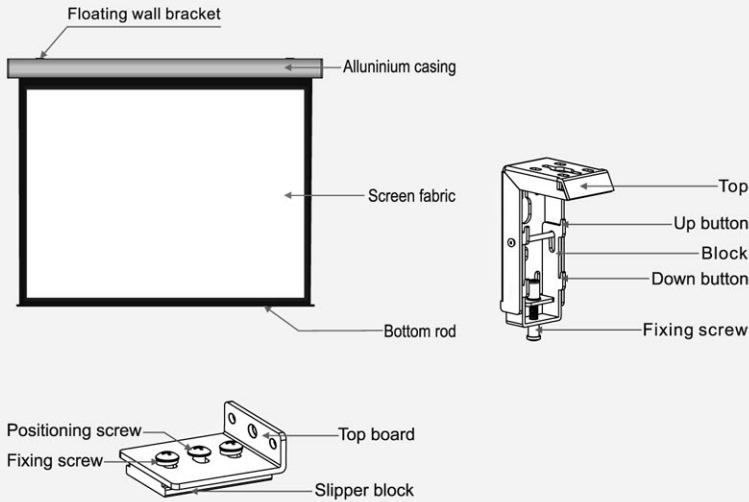

Description



Accessories

- Floating wall bracket (2pcs)
- $\phi 5 \times 40$ mm Tapping screw & cap (8sets)
- M6x10 Screw (6pcs)
- Top Board (2pcs)
- $\phi 5 \times 60$ mm Wood screw (8pcs)
- Instruction manual (1pc)
- Spring Washer (4pcs)

SETTING UP THE SCREEN - general tips

- Check that the product is delivered complete and in undamaged condition before attempting to install the product.
- See whether it is physically possible to mount the screen in the intended place. Make allowance for the load-bearing capacity of the wall and the securing points.
- Make certain that the bottom of the screen hangs sufficiently high (between 100 cm and 125 cm clear of the floor for 4:3 and 70 cm and 90 cm for 16:9). This will provide optimum viewing comfort.
- Assembly is generally easier with 2 pair of hands.

INSTALLATION

There are three different ways to mount your screen.

- **Wall mounting** (requires use of the “floating wall bracket”)
- **Ceiling mounting** (requires use of the “floating wall bracket”)
- **Suspended ceiling mounting** (requires use of the “top board” and additional hangers/hooks (not included))

Note: The ideal position for the mounting brackets is as close to the ends of the casing as possible.

A. WALL MOUNTING / CEILING MOUNTING

Make sure you use the correct screws for your type of wall/ceiling. Wood screws for wooden walls/ceilings and tapping screws and caps for concrete walls/ceilings. Both types are included.

1. Position the brackets so that they are level

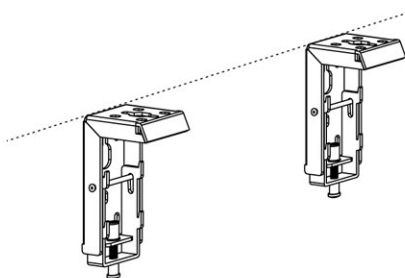

2. Drill the screws through the appropriate holes in the brackets

WOOD/WALL

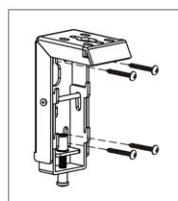

WOOD/CEILING

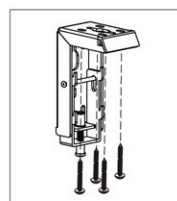

CONCRETE/WALL

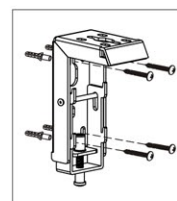

CONCRETE/CEILING

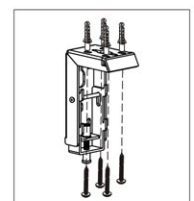

3. Loosen the fixing screw to lower down the block all the way

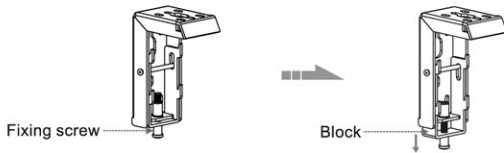

4. Slide the casing onto the ridges of the brackets

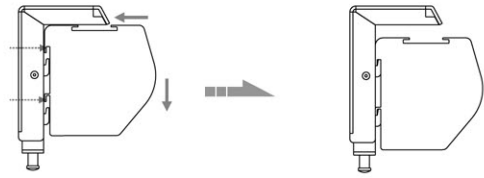

5. Fasten the fixing screws on the brackets so that the brackets fit tightly onto the casing of the screen

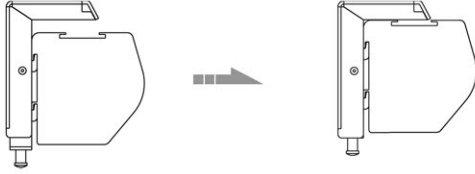

B. SUSPENDED CEILING MOUNTING

Make sure you use the correct screws for your type of wall/ceiling. Wood screws for wooden walls/ceilings and tapping screws and caps for drywall and concrete walls/ceilings. Both types are included.

1. Mount your hangers/hooks (not included) to the ceiling

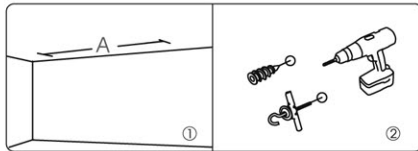

2. On top of the casing there are sliding blocks. You will need to fix the "top boards" to these as shown. Use the M6x10 screws to do so. The outer screws (tightening screws) can be fastened tightly (add washers), but don't tighten the middle screw yet (positioning screws).

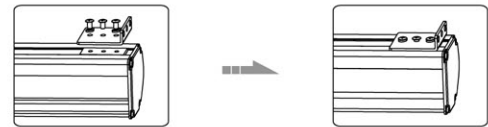

3. Put the hooks or hangers through the middle holes on the top boards. If the screen is not level, please adjust the position of the top boards. If the screen is in the desired position, tighten the screws and make sure the hooks or hangers are attached in a secure manner to avoid the screen from falling down.

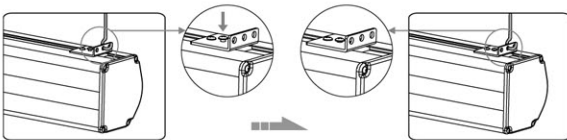

MAINTENANCE

A screen has a long service life provided it is used correctly. The following tips will help you to get the most out of your screen.

1. Protect the projection fabric from dust and smoke. Roll up when not in use.
2. Ensure when rolling up that the fabric is completely free of dust or other impurities.
3. Do not write on the fabric. It can be cleaned only to a limited extent, using a mild soap solution.
4. Do not leave the fabric exposed to direct sunlight for long periods. Direct sunlight may cause a yellow discoloration.

DISCLAIMER

The guarantee on the R-series is 2 years. The guarantee ceases to apply if the screen is not installed correctly, opened or used for any other purpose other than for which it has been designed.

Projection quality depends on many factors and will vary in different surroundings. Beamax can not offer any guarantee regarding perceived projection quality. Changes may be made without prior notice.

Tel: +32 11 40 30 90

UK free call: 0800 9175 943

E-mail: info@beamax.com

Visit www.beamax.com for the latest news on Beamax projection screens.